

Goldhurst Terrace, South Hampstead London



- Fantastic 2 double bedroom, 2 bathroom, garden flat
- Landscaped south east facing rear garden
- EPC: C. Council Tax: E. Share of Freehold 999 from 2017
- Private entrance, reception with high ceiling, recessed fitted kitchen and wood flooring throughout
- Both bedrooms overlooking the garden
- Viewing via Sole Agent Rose & Co Estates 020 7372 8488.



Asking Price £690,000 Subject to contract

Approximate Gross Internal Area
68.9 sq m / 742 sq ft

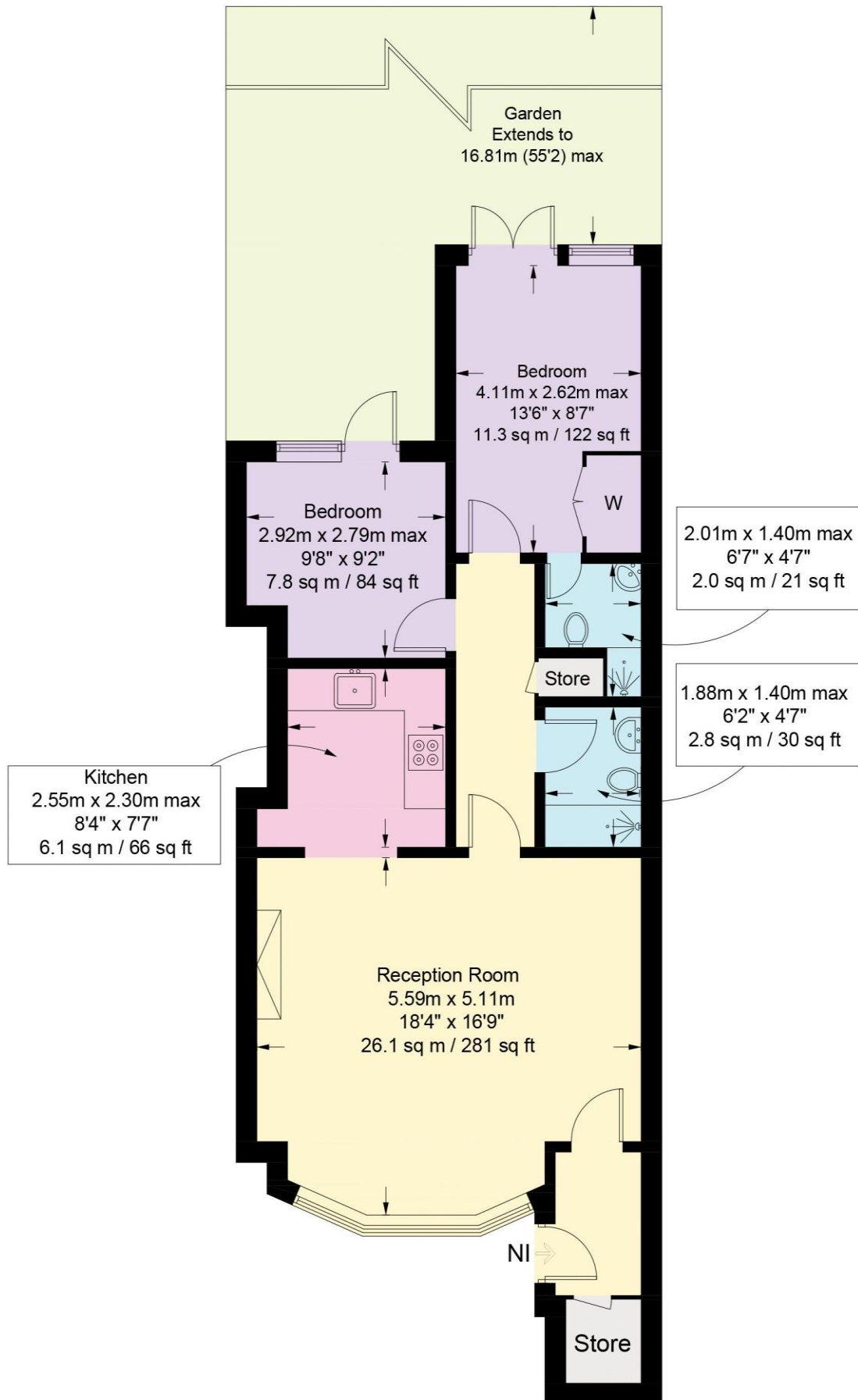

Lower Ground Floor

Illustration for identification purposes only, measurements are approximate,
not to scale. floorplansUsketch.com © (ID975874)

Energy performance certificate (EPC)

Garden Flat 141 Goldhurst Terrace LONDON NW6 3EU	Energy rating C	Valid until: 18 April 2033
		Certificate number: 0360-2248-7240-2097-1681

Property type

Basement flat

Total floor area

71 square metres

Rules on letting this property

Properties can be let if they have an energy rating from A to E.

You can read [guidance for landlords on the regulations and exemptions \(https://www.gov.uk/guidance/domestic-private-rented-property-minimum-energy-efficiency-standard-landlord-guidance\)](https://www.gov.uk/guidance/domestic-private-rented-property-minimum-energy-efficiency-standard-landlord-guidance).

Energy efficiency rating for this property

This property's current energy rating is C. It has the potential to be C.

[See how to improve this property's energy performance.](#)